

## CS-10 Stereo Micro Monitor Specifications

- Output 6W RMS
- Speaker 2" x 2, 5" x 1
- Input L and R  
RCA Pin x 2
- Output 1/8" Headphone
- Controls Volume (Main input only), Tone
- Dimensions 11 3/16" x 3 5/16" x 9 1/2"
- Weight 3 lbs. 5 oz.

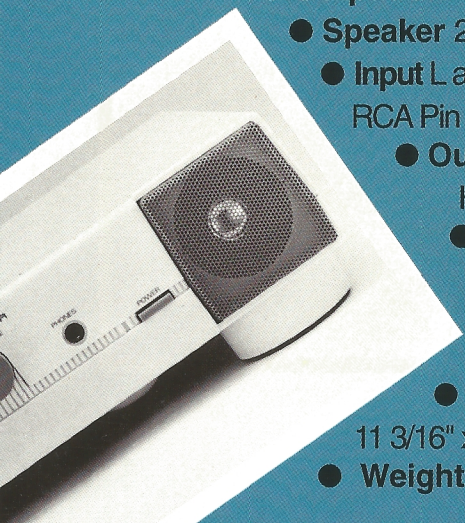

## Roland Audio Monitors Offer Tremendous Input Versatility

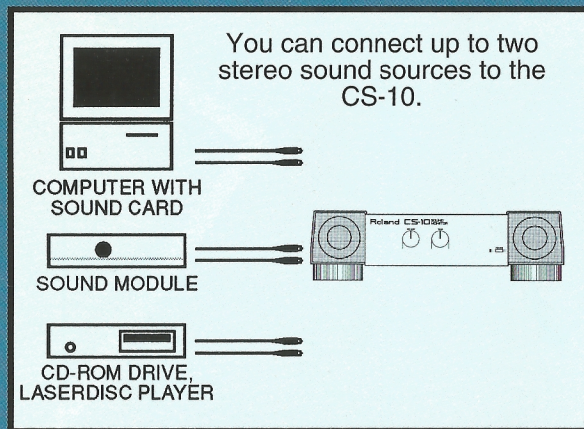
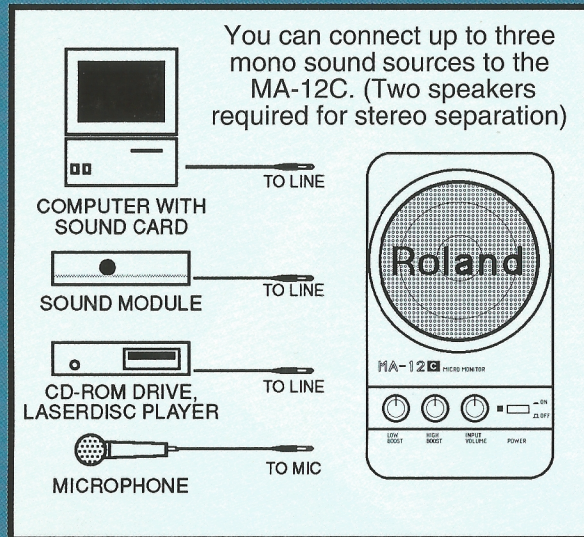

## MA-12C Micro Monitor Specifications

- Output 10W RMS
- Speaker 4" Full-range
- Inputs 1/4" Mic (-45dBm)
- Line (-15dBm)
- Instrument (-15dBm)
- Controls Input Volume, Low Boost, High Boost
- Dimensions 5 3/16" x 6 1/2" x 8 9/16"
- Weight 5 lbs. 2 oz.

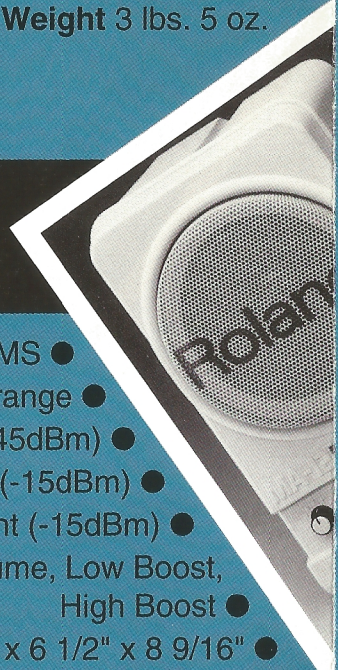

Roland®

## Computer Audio Monitors

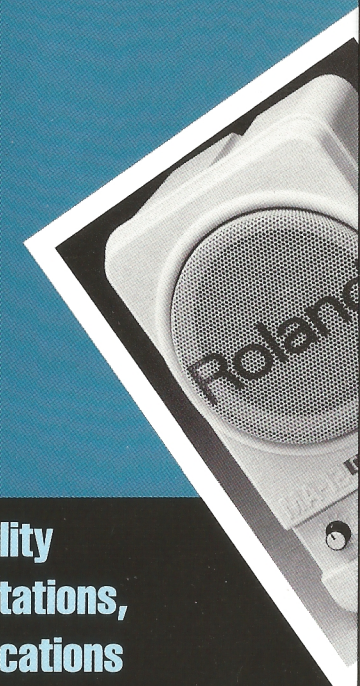
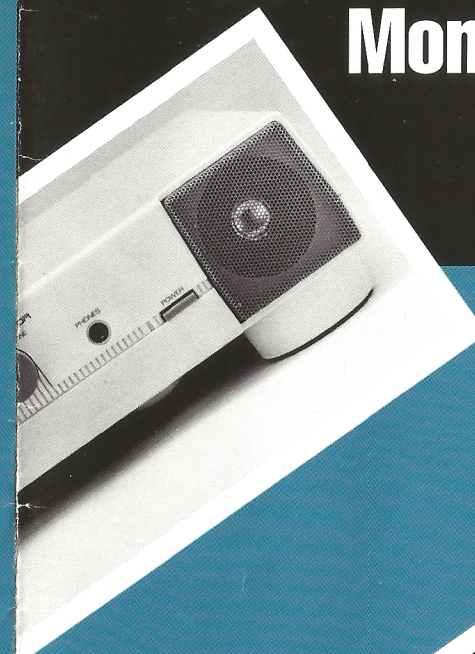

Professional-quality audio for presentations, multi-media applications and entertainment

Roland®

Roland Corporation US  
7200 Dominion Circle  
Los Angeles, CA 90040-3647  
Tel. (213) 685-5141 Fax (213) 722 0911

# CS-10 Stereo Micro Monitor

The CS-10 Stereo Monitor Amplifier is an integrated stereo amplifier and speaker system that conserves desktop space by fitting perfectly under your computer's CRT.

Designed for personal desktop use, the CS-10 allows you to take advantage of the sound capabilities of computerized training systems, in-house multimedia and music authoring systems, voice-mail, computer games and entertainment programs. The CS-10 features two stereo line inputs for connecting CD-ROMs, laserdiscs, audio cards or MIDI sound modules.

The CS-10 is magnetically shielded to prevent damage to data on floppy disks and distortion of the CRT display. The CS-10 offers superb design and features that make it the ideal sound reproduction system for computer users who are looking for compact, quality sound at a very affordable price.

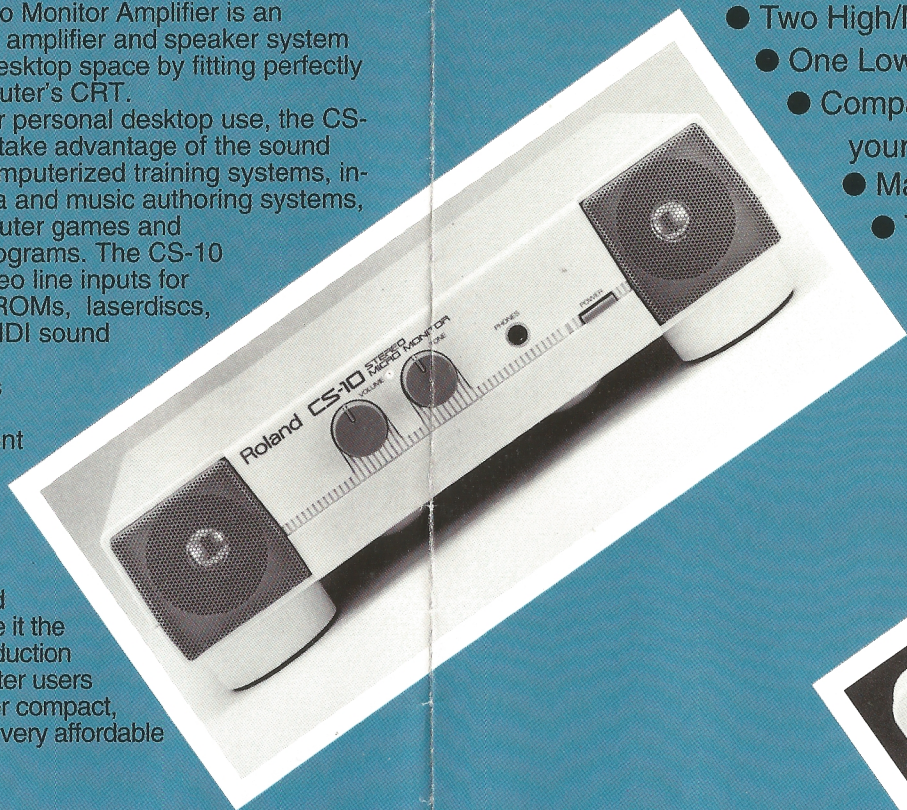

- Two High/Mid-range speakers
- One Low-range speaker
- Compact design, fits under your monitor
- Magnetically shielded
- Two stereo inputs for mixing sound sources

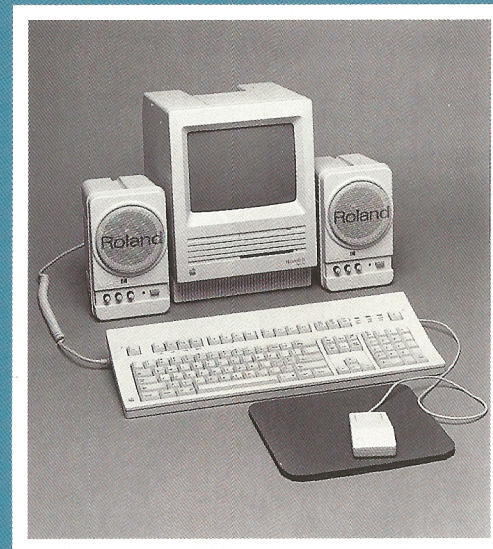

The MA-12C Micro Monitor is perfect for multimedia presentations and other applications that require the highest quality audio. With a compact design that compliments your computer, the MA-12C fits easily on a shelf or on the desktop, and since it's magnetically shielded, it won't interfere with the operation of your monitor.

The MA-12C features a powerful four-inch speaker and ten-watt RMS power amplifier, plus two line-level inputs allowing simultaneous playback of multiple sound sources such as CD and laserdisc audio, audio cards and MIDI modules.

A third input accepts a microphone, making the MA-12C perfect for voice-overs and lectures. Low and high boost controls with active circuitry allow you to adjust the sound to any environment.



- 4" full-range speaker
- 10W RMS Amplifier
- Mic, Instrument and Line inputs
- Magnetically shielded
- Active Low and High Boost controls
- Attractive, compact design



## Micro Monitor MA-12C